

E1000

Exposed Fastener Attachment System

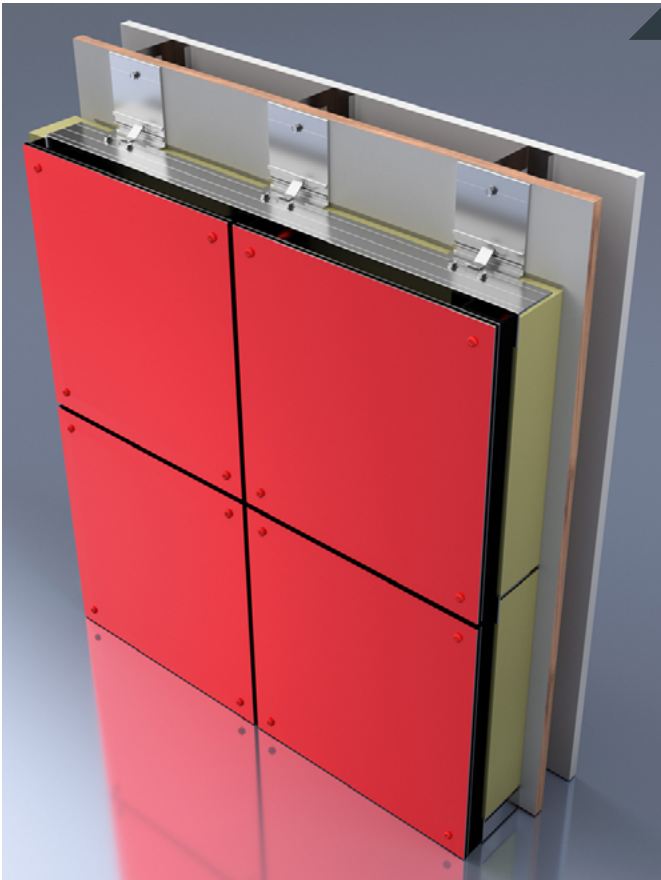

Exposed Fastener Attachment System

CEI Materials E1000 Exposed Fastener Attachment Systems are cost effective yet still offer an architecturally attractive look.

System Characteristics:

- Drained Back Ventilated Rainscreen
- Easily Installed
- Low Maintenance
- Economical
- Available With HPL, MCM or Aluminum Plate

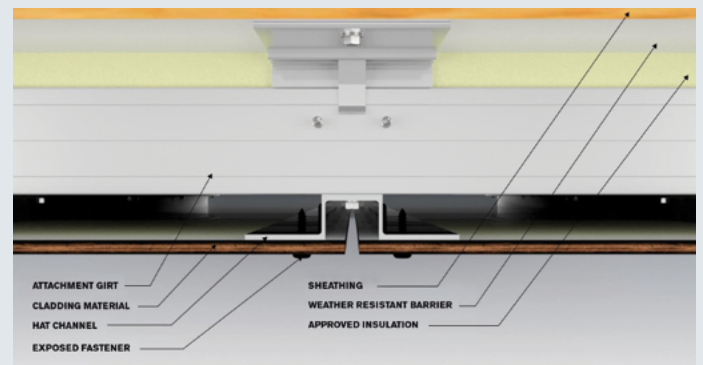

E1000

Exposed Fastener Attachment System

TECHNICAL DETAILS

Face Material:

- MCM
- HPL
- Aluminum Plate Alloy 3030 & 5052

System Depth:

- MCM: 1 ³/₁₆"
- HPL: 1 ⁵/₁₆"
- Plate: 1 ¹/₈"

Panel Extrusions:

- Aluminum Alloy: 6063-T6
- Mill Finish or Black Anodized Hat & J Channel

Fabricated Panel Tolerance:

Length: Plus 1mm (0.0394")

Width: Plus 1mm (0.0394")

Depth: Plus or minus 0.2mm (0.008")

Squareness: .5mm (0.016") maximum

Tested Systems & Code Compliance:

At CEI Materials we are dedicated to making sure that our cladding systems meet and exceed all the project specific requirements for performance and adherence to local & International Building Code standards. Depending on the system we will clearly identify what tests and procedures were completed internally and with third party assistance.

ASTM E 283 - Static Air Infiltration

ASTM E 330 - Structural Design loads (40psf)

ASTM E 331 - Static Water Infiltration

AAMA 501.1 - Dynamic Water Infiltration Test

AAMA 509 - Drained & Back Ventilated Rainscreen Test

NFPA 285 - Multi-Story Flame Spread Test
(HPL & Aluminum Plate)

Florida Product Approval

System Details:

All system details at CEI Materials are available in Autocad & Revit.